

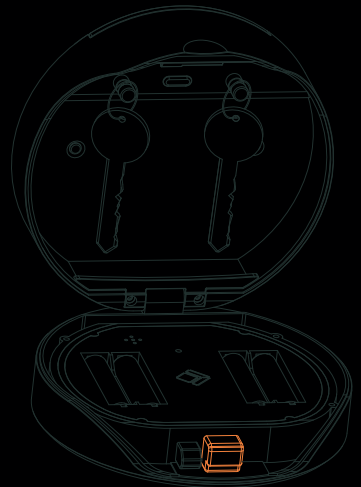

# Smart-Box User Guide

**Model K12**

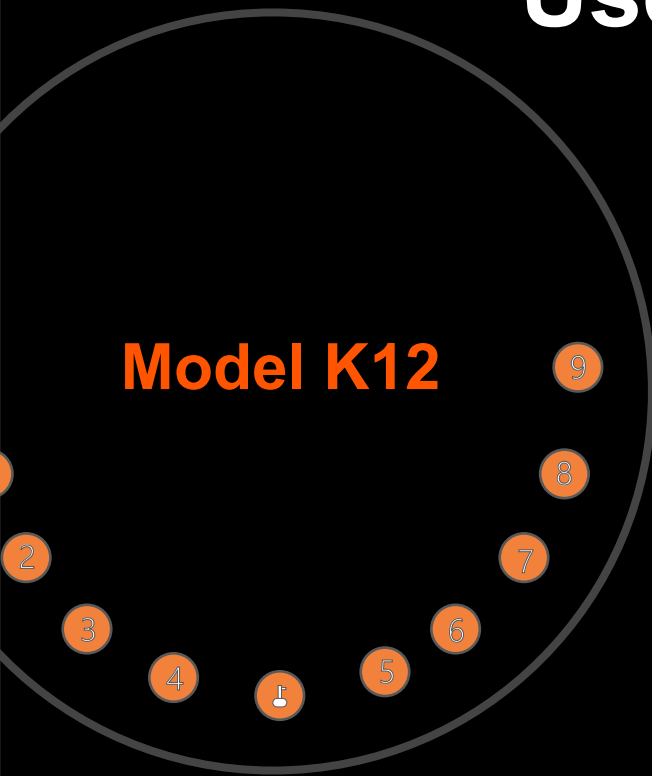

**Secure Solutions for Protecting Your Keys**

**[www.keyboxsystems.com](http://www.keyboxsystems.com)**

# What's Included

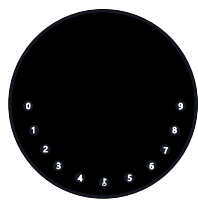

1 x Key Box



1 x HELLO Card



2 x Screw Cap

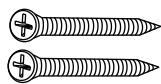

2 x Mounting Screws



2 x Screws Anchors



1 x Reset Tool

# Specification

Model	K12
Material	Body Zinc Alloy, SUS304
Battery	4 x AAA Alkaline Battery
Unlock Mechanism	Bluetooth, PIN Code, App
Jump Start	USB-C

Front

Inside

Back

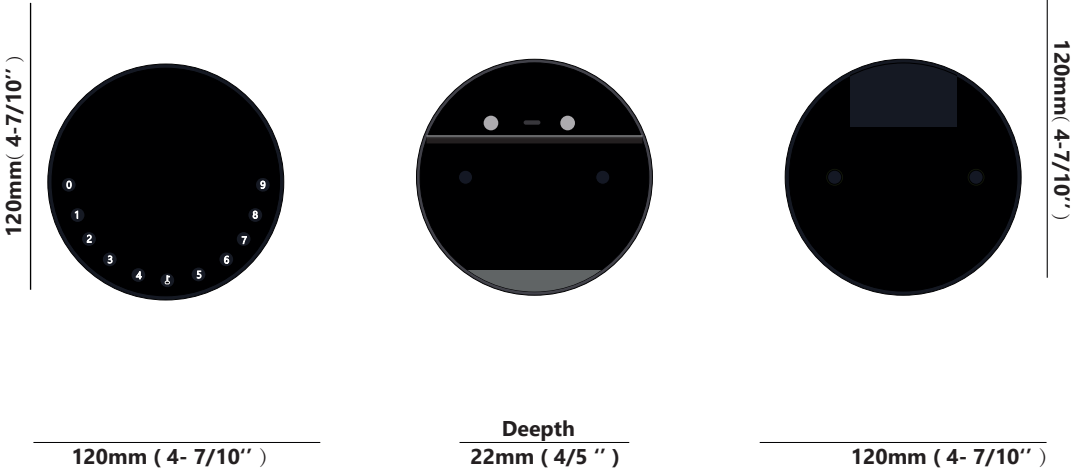

# Features

## Lock&Unlock



### Administrator Unlock

Set a Master Administrator PIN for Unlocking, settings, operations etc. and only the administrator could change the administrator PIN code.



### User Unlock

This KeyBox allows to add up to 100 user PIN codes for your family, friends and visitors.



### Anti-peeping

Add up to 8-12 digits before and after PIN code to intensify your PINs.



### Auto Locking

If there is no opening motion in 10 seconds the box will be automatically locked.

## Mobile Control



### Bluetooth one-touch unlock

With your Mobile you could unlock the keybox by touching the UNLOCK key on the App.



### Offline Unlock

You could generate offline code through mobile App, for scheduled access, parcel delivery, house keeping, etc.



### Mobile Administrator

Set Administrator PIN Codes from your Mobile to unlock, add users, delete users, etc.

## Battery



### Battery Life

4 AAA batteries, the life cycle will be more than 12 months, please use good batteries.



### Low Battery

When the battery runs out of power, system will remind you to replace the batteries.



### Low Consumption

BLE broadcasting turns to sleep mode if no operations.

## Emergency



### Jump Start

When the power is down and use USB-C to jump start the lock and get it unlocked



### System Lockdown

The lock will be lockdown for 5 minutes if continuously enter wrong PINs for 5 times.

## Quick Start

### Step 1 > Install Battery

>. Rmove the (4) screws on the battery cover

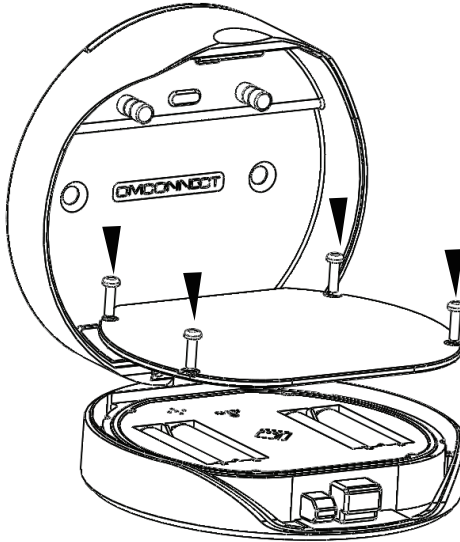

>. Put 4 AAA batteries into the battery dock.

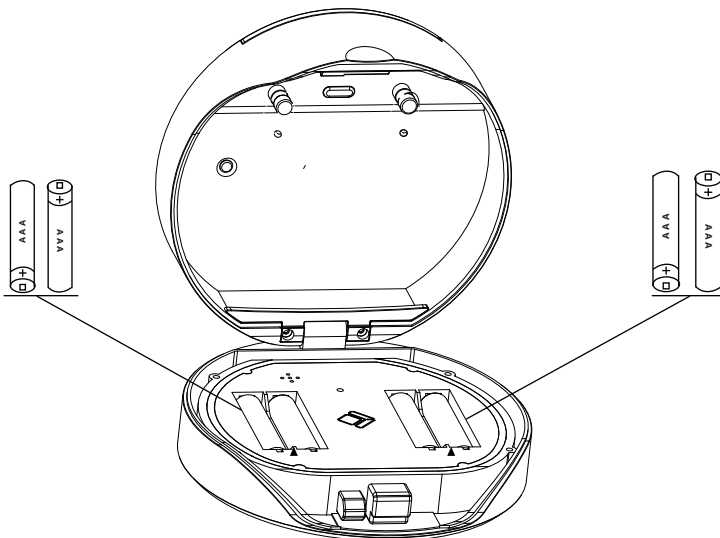

## Step 2>Download Mobile App

>1. Scan QR Code below and download the App and turn on your mobile Bluetooth



## Step 3>Add Device

>1. Go to App Home page, click Add Device or click "+" on the upper right.

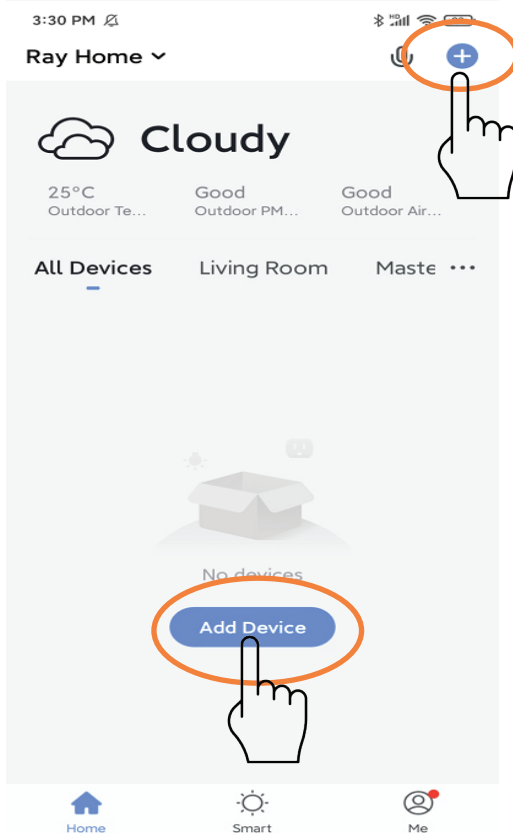

> **2.** Press the “Reset” button and hold it for 3 beeps to start pairing

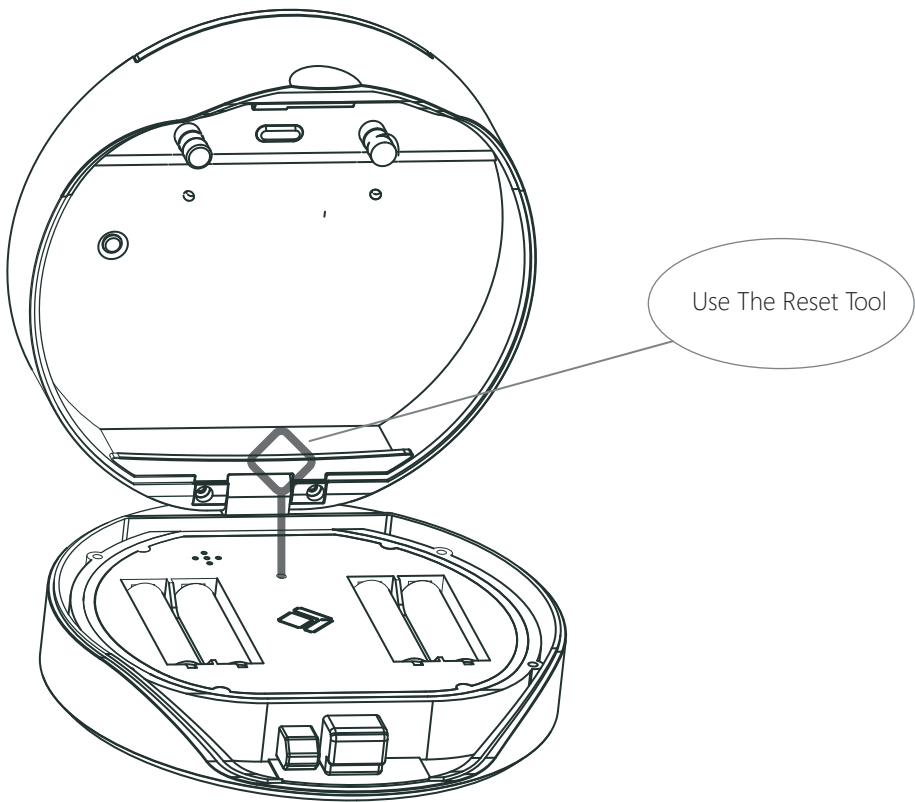

>3. You will see the detected device and click “Go to add”.

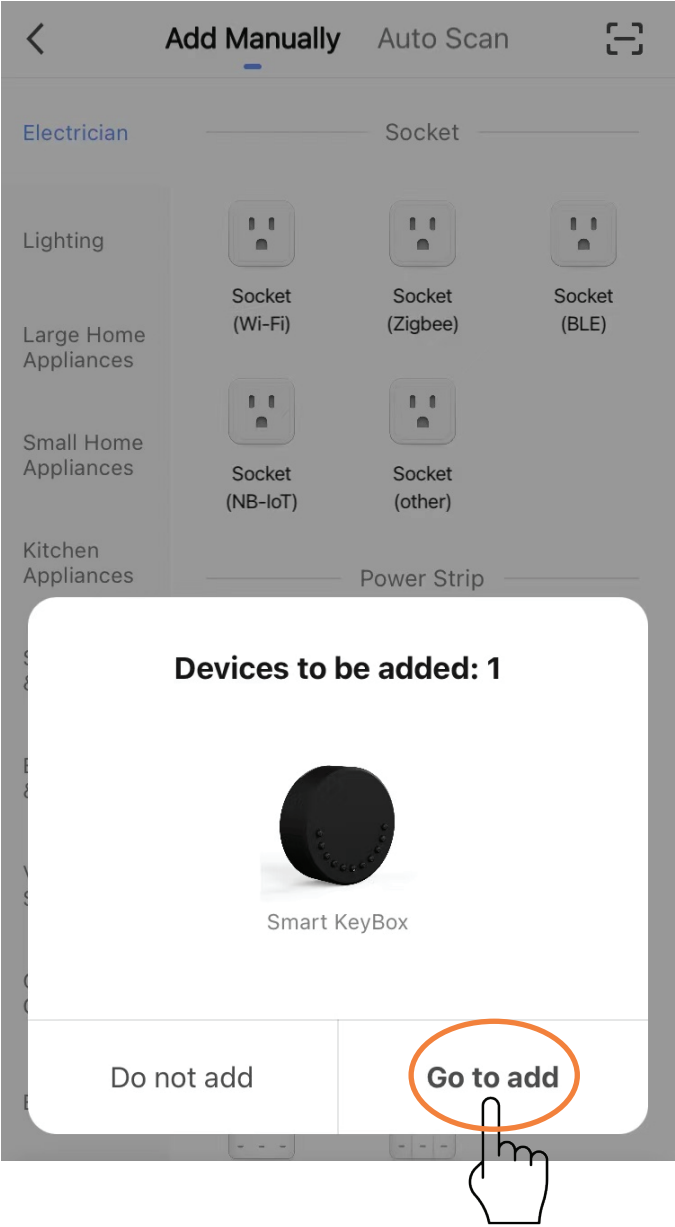



>4. Connecting, you need to wait for few seconds to let it finish.

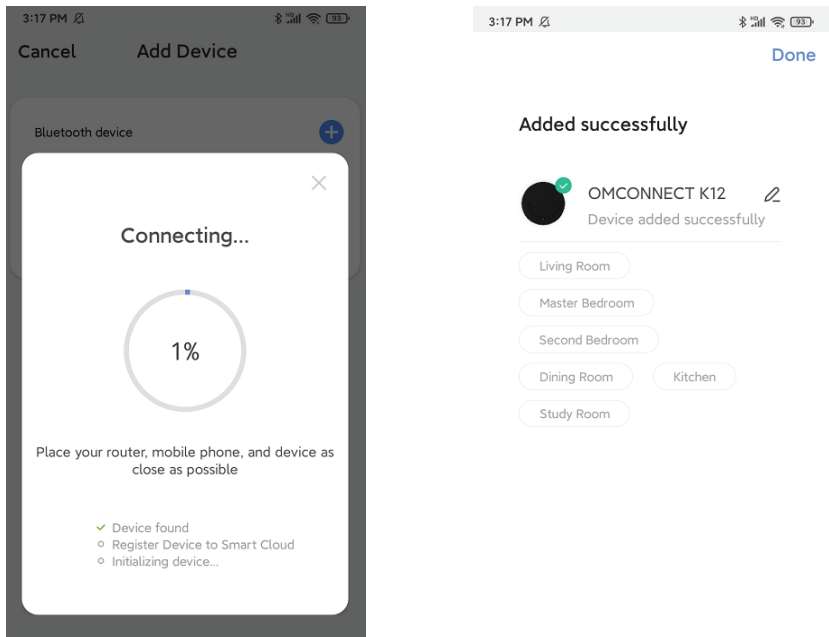

>5. Device added

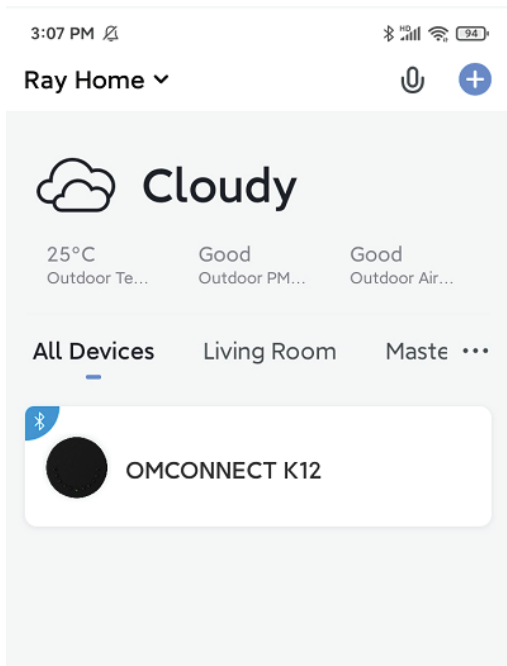

## Step 4>Change Admin Password-Initial Admin Password:123456

>1. Press the Enter Button and hold for 3 beeps

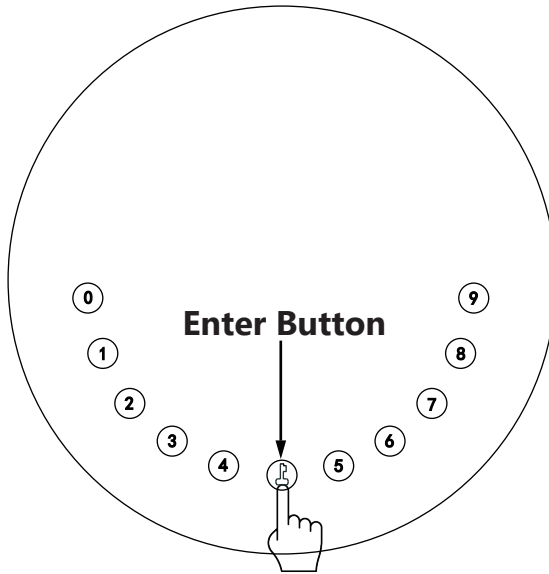

>2. Right after the 3 beeps please key in:

Initial Admin Password + Enter Button+New Admin password+Enter Button

# Mechanical Instructions

## Password & Factory Mode:

### 1. Password Length

☒ Password must be 6 digits(no more no less)

### 2. Add User PIN

☒ Press Enter and hold for 3 beeps, Admin PIN + enter + user PIN + enter + user PIN + enter

### 3. Modify User PIN

☒ Enter + 1 + Enter, PIN to be modified + enter + New PIN + enter + New PIN + Enter

### 4. Delete User PIN

☒ Enter + 2 + Enter, Admin PIN + PIN to be deleted + enter

### 5. Delete All User PINs

☒ Enter + 00000 +Enter + Admin PIN and wait for 3 seconds

### 6. Virtual digits-Anti Peeping

☒ Add any digits before and after the correct password the KeyBox unlock as always

### 7. System Lockdown

☒ KeyBox will Lockdown for 5 minutes if entering wrong password continuously 5 times

### 8. Reset Factory Mode

☒ Press and hold the reset button for 5seconds and with a long beep

## Bluetooth broadcasting & re-connecting:

☒ Press and hold the reset button for 3 beeps, you will be able to pair the device.

☒ Bluetooth broadcasting will turn to sleep mode if no operations within 1 minute.

☒ Press any key to activate the Bluetooth, App&Device will get reconnected each other.

# App Instructions

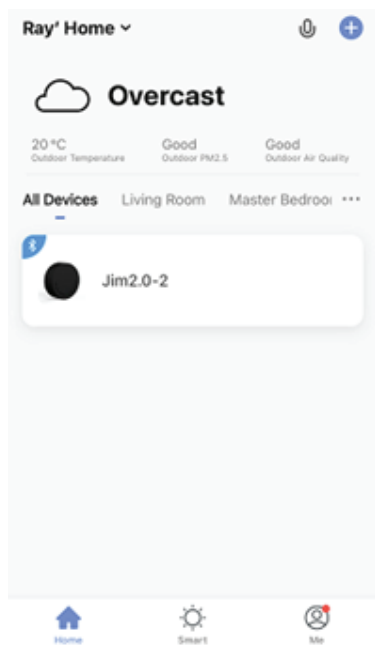

☑ You will see all devices and rooms on the home page.

☑ Tap the Device to start operating.

☑ Tap "Me" at the bottom to manage your home.

☑ Touch the lock sign to unlock and lock.

☑ Tap "Bell" sign to check the alarm records.

☑ Tap "Member Managemen to add or delete members.

☑ Tap "opening record" to check opening logs.

☑ Tap "Intelligent Linkage" to turn on and off go home mode.

☑ Tap "Set" to manage passwords



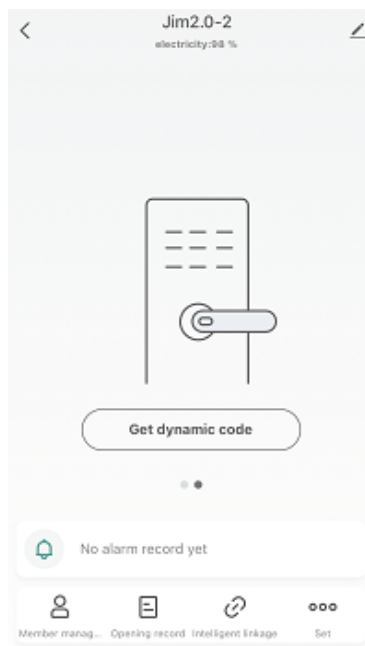

☑ Tap "Get dynamic code" to get a code.

☑ Tap "copy code" and send it to friend or family.

☑ Tap "Pen" sign to edit your personal information.

☑ Tap "+" to add family member or others.

☑ Tap added members to edit member's information.

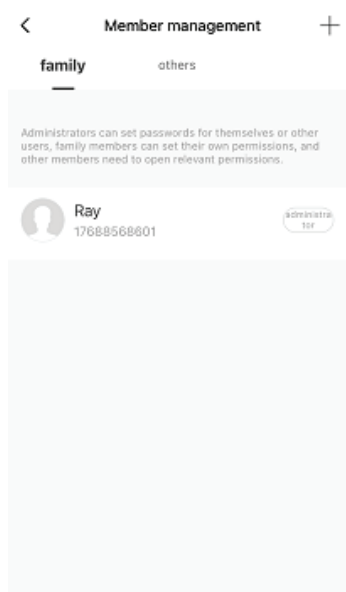

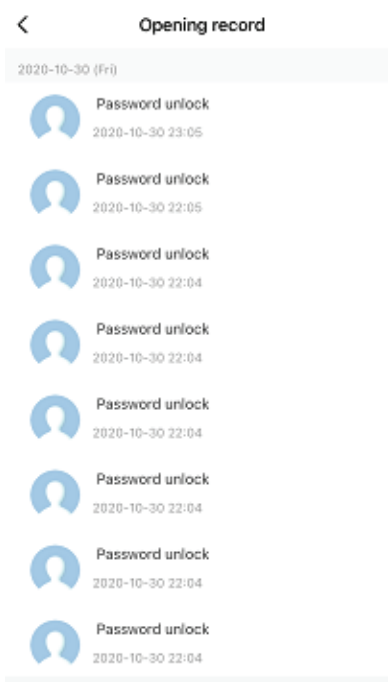

☒ You will find out when and who unlocked the KeyBox

☒ Tap the green bar and save to turn on the function.

☒ Tap the orange bar and save to turn on the function.

☒ You will get notification if user unlocked with bluetooth

☒ Go to "me" homepage and got to message center to check the records.

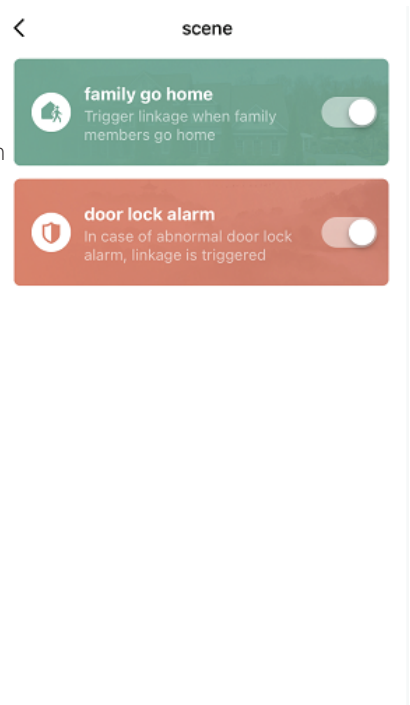



## Set



password man... Temporary pas...

Intelligent linkage



☑ Tap “password management” to add or remove codes.

☑ Tap “Temporary code” to manage online and offline codes.

☑ Tap “one time code” under Online Code to set a online one time code.

☑ Tap “periodic Code” under Online Code to set a online code which will be available in a period of time.

☑ Tap “One Time Code” under Offline Code to generate a one time offline code which will be a 10 digits code and use it when the device is offline.

☑ Tap “ Offline Temporary Code” under Offline Code to generate a offline code(10 digits) which will be available in a period of time, and use when the device is offline or Bluetooth disconnected with device.

☑ Tap “Clear Code” to generate a code(10 digits) which is able to clear Codes that need to be invalid or clear all codes.

☑ Please note if the code less than 10 digits you need to regenerate a new code, the code must be 10 digits.



## Temporary Code

### Online Code

It is recommended for BLE connections

#### One Time Code

It can be used only once during the validity period



#### Periodic Code

Can be used multiple times within the validity period



### Offline Code

It is recommended to use when BLE is disconnected or in a poor BLE environment

#### One Time Code

It can be used only once during the validity period



#### Offline Temporary Code

Please use it at least once within 24 hours after it takes effect, or it will be invalid



#### Clear Code



# Smart-Box Innovation Key Storage Solutions



The diagram shows a large, light gray circular outline. Inside this circle, the text "Model K12" is centered. Surrounding the text are nine smaller, light gray circles arranged in a ring. Each of these smaller circles contains a number from 1 to 9, starting from the top right and moving clockwise. The number 1 is replaced by a white key icon. The numbers 2 through 9 are in a light gray font.

## Model K12

For Information Please Contact US

Distributed/Supported in North America by

**Time Access Systems Inc**

Phone (604) 460-8670 Toll Free 1-877-460-9602

[www.keyboxsystems.com](http://www.keyboxsystems.com)